

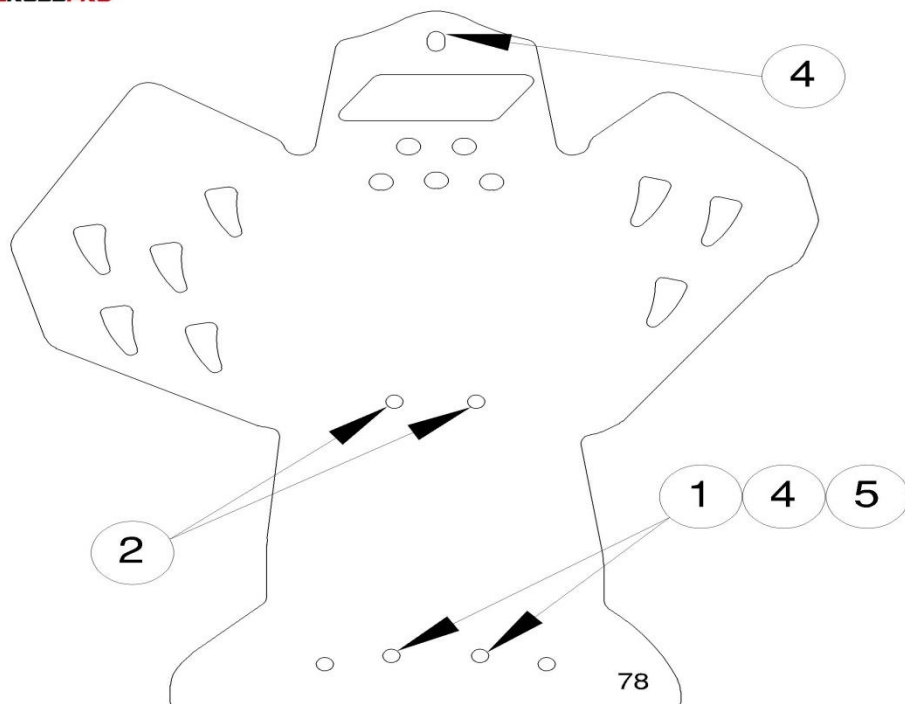

Engine Guard DTC-EC
HUSQVARNA TE TC 250-310 – 11/12
Ref: 2CP0850078

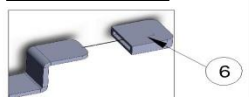

ASSEMBLY RUBBER CAP



6	-	Rubber Cap / Cápsula de Borracha	-	2
5	-	Clip Inox / Mola de Frizo	M6	4
4	-	Screw Round Head With Washer False / Paraf. Cabeça Redonda Sext. Int. c/ FA	M6 x 25 - ISO 7380	3
3	-	Screw Round Head With Washer False / Paraf. Cabeça Redonda Sext. Int. c/ FA	M6 x 20 - ISO 7380	2
2	-	Clamp Inox / Fixação Inox	Nº1	2
1	-	Bushing DTC / Casquilho DTC	Ø25 x Ø10 x 6mm	2
Item Nº	Referencia	Componente (Component)	Descrição (Description)	Quant

Assembly Sequence

English:

Attention – Follow the assembly instruction sequence has you can see in the photos.

Apply Rubber Cap on the Inox Clamp, assembly Rubber Cap.

- **1st Photo:** DTC Engine protection part and kit of components.
- **2nd and 3rd Photo:** Apply Item Nº5 (Clip Inox) on the rear part of the frame (2-Units).
- **4th Photo:** Apply Item Nº5 (Clip Inox) on Item Nº2 (Clamp Inox) and after in the protection using screws (item Nº3).
- **5th Photo:** Apply Item Nº1 (DTC Bushing) and item Nº4 (Screw) on the rear part of the protection and after apply on the frame of the bike (Clip Inox previously applied on the frame).
- **6th Photo:** Place in the correct position Clamp Inox and adjust screws.
- **7th Photo:** Apply Item Nº4 (Screw) on the front part of the protection and adjust.
- **8th Photo:** Tight all Screws.

Engine Guard DTC-EC
Husqvarna TE/TC 250/310 2011-2012

