

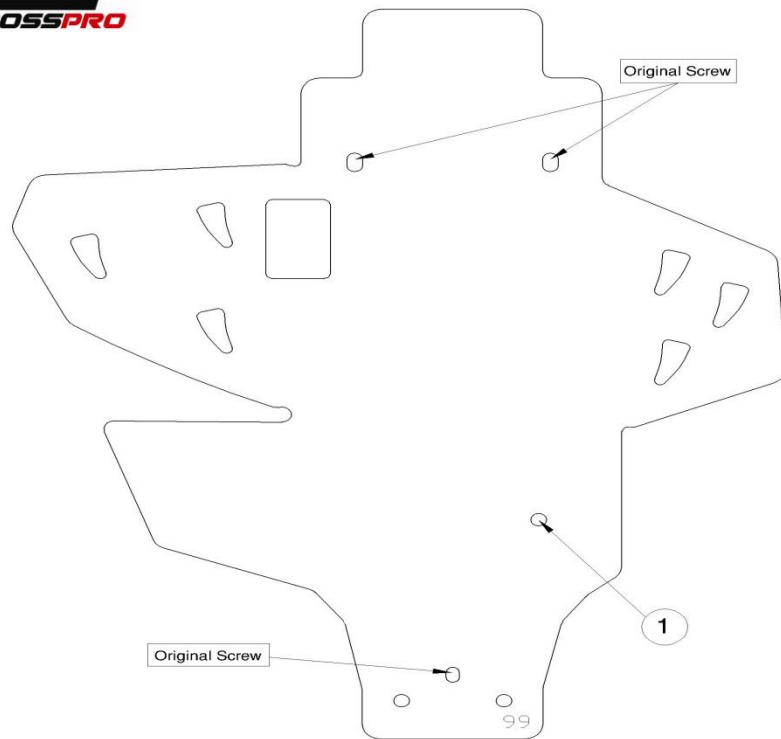

Engine Guard DTC-EC
SHERCO 250-300 2T 14/15
Ref: 2CP0850099



1



2

3

ASSEMBLY RUBBER CAP

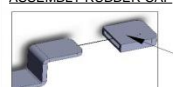

4

4	-	Rubber Cap / Cápsula de Borracha	-	1
3	-	Clip Inox / Mola de Frizo	M6	1
2	-	Screw Round Head With Washer False / Paraf. Cabeça Redonda Sext. Int. c/ FA	M6 x 20 - ISO 7380	1
1	-	Clamp Inox / Fixação Inox	Nº1	1
Item Nº	Reference	Component	Description	Quant.

Assembly Sequence

English:

Attention – Follow the assembly instruction sequence as you can see in the photos.

Apply Rubber Cap on the Inox Clamp, assembly Rubber Cap.

- **1st Photo:** DTC Engine protection part and kit of components.
- **2nd Photo:** Apply on the protection item Nº1 (Clamp INOX) using item Nº2 and item Nº3.
- **3rd Photo:** Remove exhaust front attachment to the frame.
- **4th Photo:** Mount protection on the motorcycle first front part using original screws.
- **5th Photo:** Apply rear screw (Origin Screw).
- **6th Photo:** Adjust middle clamp.
- **7th Photo:** Tight all screws.
- **8th Photo:** Reseat exhaust attachment as it was first sat.

Engine Guard DTC -EC SHERCO 250-300 2T 14/15

